

Stonehenge Road Closures – beginning June 28, 2018

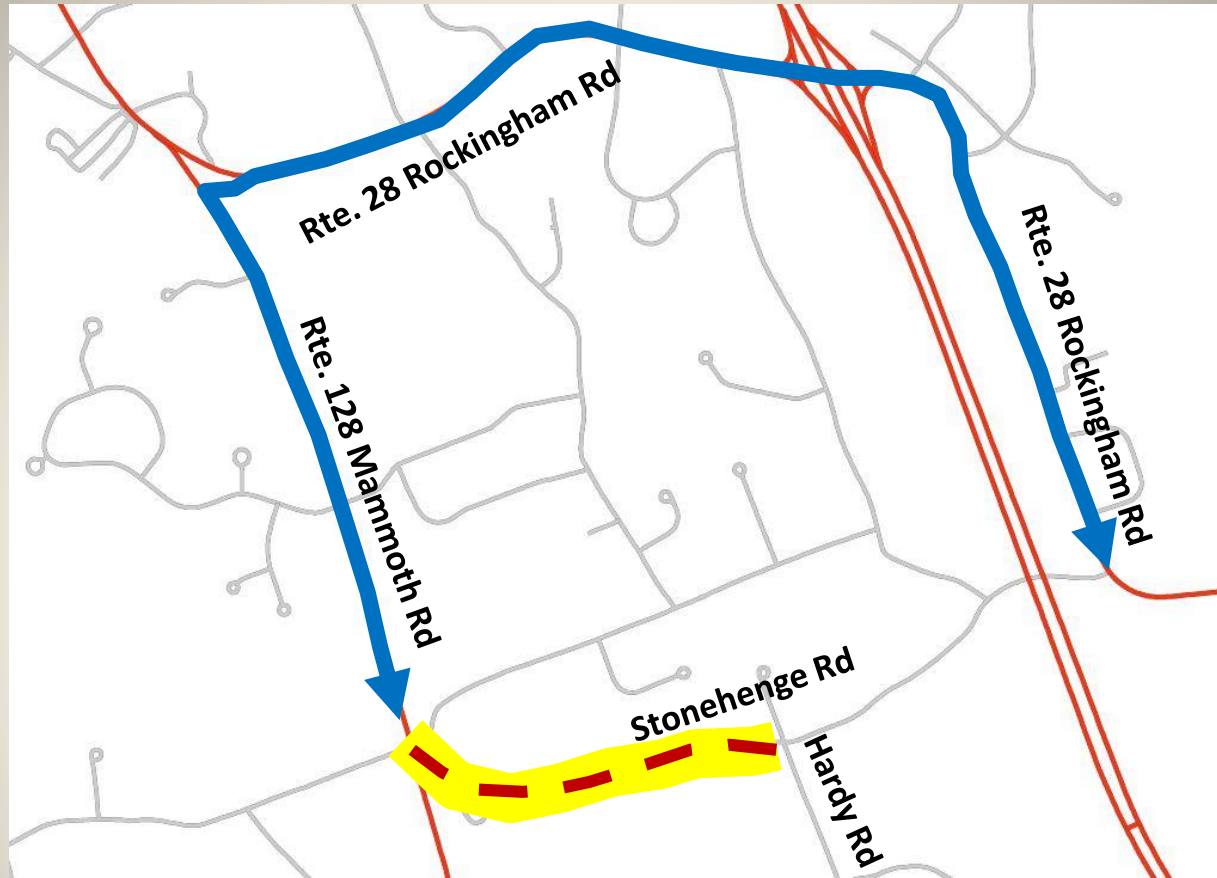
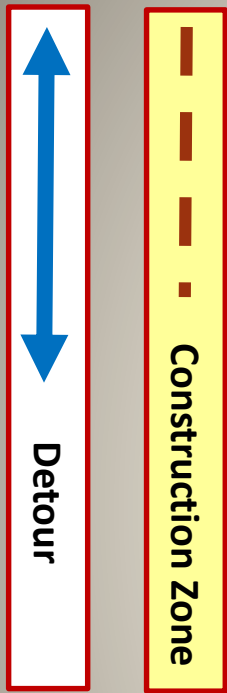

Beginning June 28, 2018 and continuing throughout the summer Stonehenge Road will have daily road closures due to construction. NO THRU TRAFFIC.

Use Rte. 28 & Rte. 128

We apologize for any inconvenience and thank you for your cooperation. Any questions contact the Dept of Public Works at 432-1100 x193